



Rhif y Cais / Application Number : C16/0725/13/AM

Cynllun lleoliad ar gyfer adnabod y safle yn unig. Dim i raddfa.
Location Plan for identification purposes only. Not to scale.



Atgynhychir y map hwn o Ddeunydd yr Ordnance Survey gyda chaniatâd yr Ordnance Survey ar ran Rheolwr Llyfrfa Eil Mawrhydi. © Hawffraint y Goron.
Mae atgynhychu heb ganiatâd yn torri hawffraint y Goron a gall hyn arwain at erlyniad neu achos sifil.
Cynllun Gwynedd - 100023387 - 2008

This map is reproduced from Ordnance Survey material with the permission of Ordnance Survey on behalf of the Controller of Her Majesty's Stationery Office.
© Crown copyright.
Unauthorised reproduction infringes Crown copyright and may lead to prosecution or civil proceedings.
Cynllun Gwynedd - 100023387 - 2008

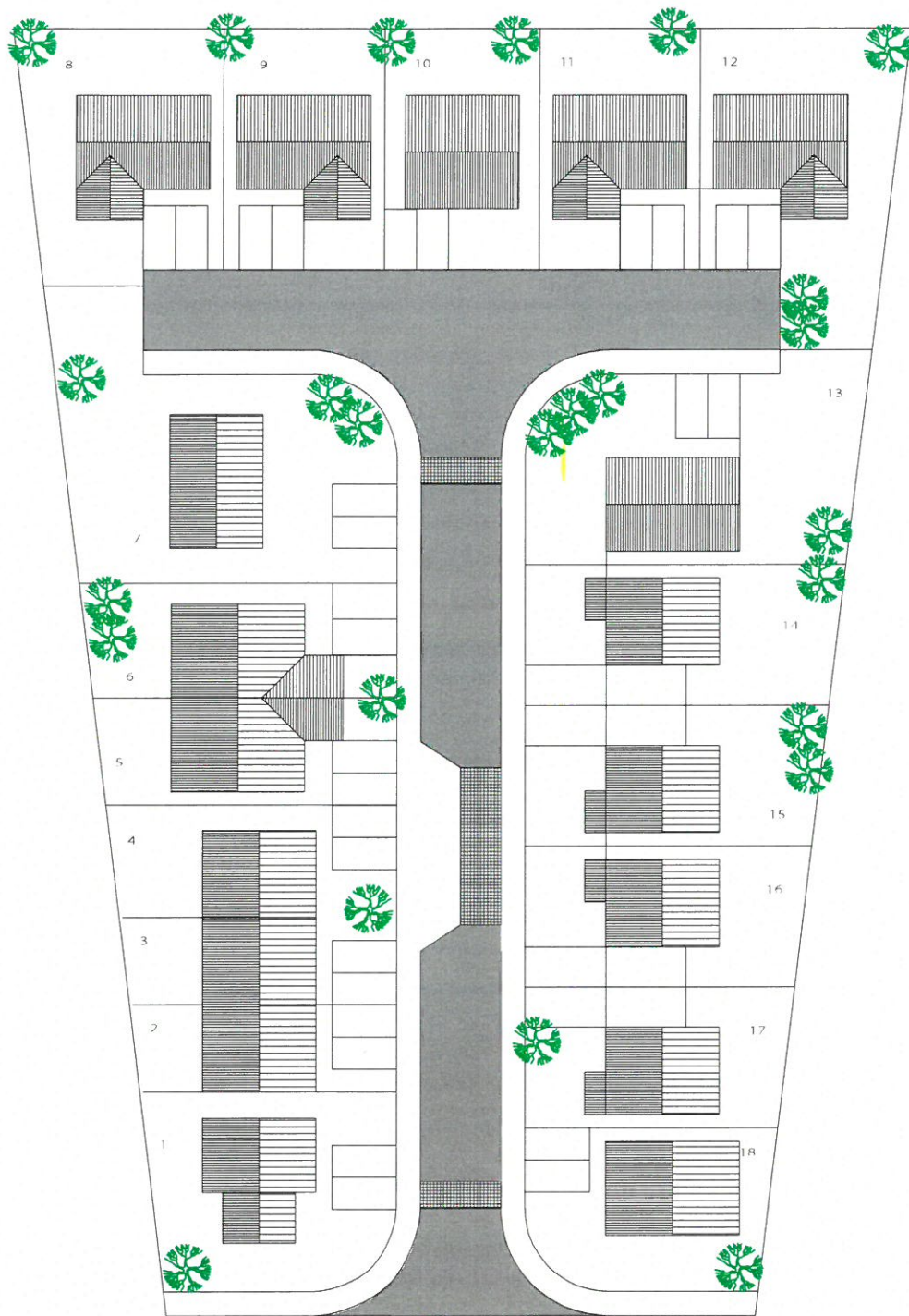

Stad Coetmor	20051:05
RACIUB	1:500
PROPOSED SITE PLAN	06/07

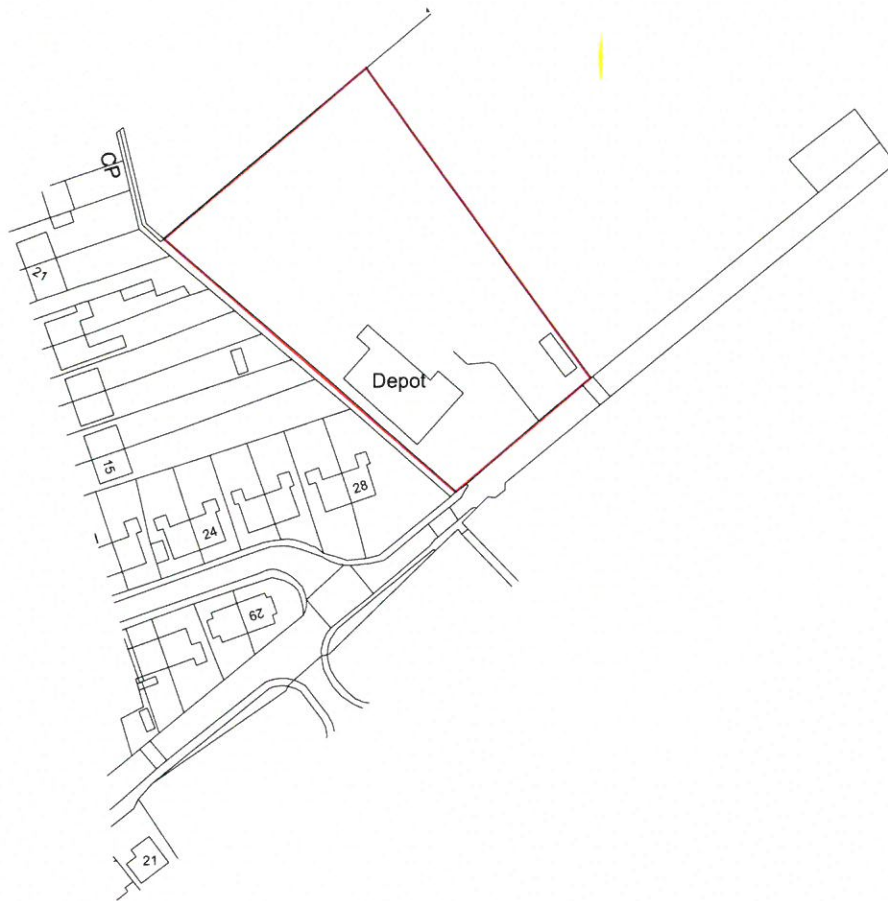

This drawing is not to be scaled, only figured dimensions, levels etc. are to be used. Any changes made to the information contained on the drawing are to be agreed in writing with WM Design & Architecture Ltd. This drawing is Copyright and is protected by the Design Copyright Act 1988 and cannot be reproduced without permission.
 This drawing is to be read in conjunction with the printed specification provided by WM Design & Architecture Ltd, Pine House, St Georges road, Waverley Bridge, Angsey.



+44 (0) 1248 717230
 +44 (0) 1248 714930
 o.office@wmdesign.co.uk
 wmdesign.co.uk

Project Title	Proposed New Housing Development
Location	Site adj Sport Centre, Bethesda
Client	R Williams & R Moore
Drawing Title	Site Location

Scale	1:1250
Paper Size	A4
Date	6/24/13
Issue Type	Planning
Drawn By	PJ
Drawing Details	Job No. SH1265 Drawing No. AL 0 SITE Revisions